

HR Range

HR(Hight Rate)range Valve Regulated Lead Acid (VRLA) batteries have been developed with high efficiency active materials to stimulate inside the battery with higher power output when the battery is discharged to a extent level of discharging. Along with high-density structure design for relatively smaller inner resistance which will significantly improve the performance for high rate discharging when high power output service is needed.

Application

- Alarm System
- Cable Television
- Cable Television
- Communication Equipment
- Control Equipment
- Security System
- Medical Equipment
- Toys
- UPS
- Emergency Power System

General Features

- Sealed and maintenance free operation.
- Non-Spillable construction design.
- ABS containers and covers(UL94HB, UL94V-0) optional.
- Safety valve installation for explosion proof.
- High quality and high reliability.
- Exceptional deep discharge recovery performance.
- Low self discharge characteristic.
- Flexibility design for multiple install positions.

Construction

- ComponentRaw material
- PositiveLead dioxide
- NegativeLead
- ContainerABS
- CoverABS
- SealantEpoxy Resin
- Safety valveEPDR
- TerminalCopper
- SeparatorFiber glass
- ElectrolyteSulfuric acid

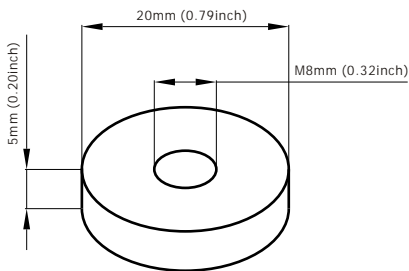

Standard Terminal Dimensions
(Optional terminal please check terminal information page)

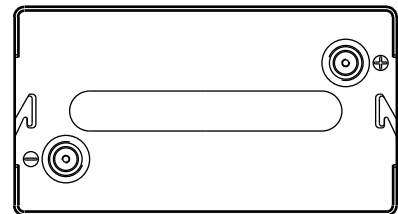
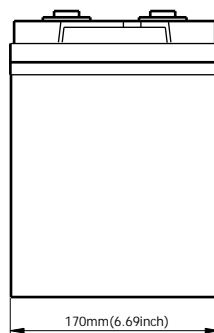
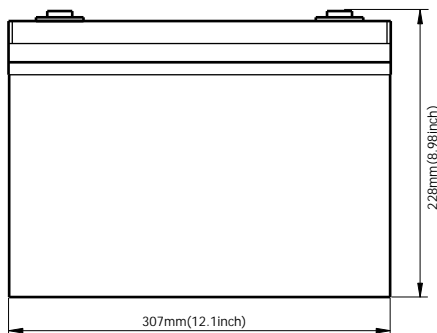

Battery Model	GT6-180HR			
Designed Floating Life	6-8 Years			
Capacity(25°C)	20HR(9.02A,1.75V)	10HR(18A,1.75V)	5HR(32.4A,1.75V)	1HR(114A,1.75V)
	180AH	180AH	162AH	114AH
Dimensions	Length	Width	Height	Total Height
	307mm(12.09inch)	170mm(6.69inch)	223mm(8.78inch)	228mm(8.98inch)
Approx. Weight	28.0Kg (61.7 lbs)			
Internal Resistance	Full charged at 25°C :0.0033 Ohm			
Self Discharge	3% of capacity declined per month at (25°C)			
Capacity Affected by Temp.(20HR)	40°C	25°C	0°C	-15°C
	102%	100%	85%	65%
Charge Voltage(25°C)	Cycle use		Float use	
	7.2-7.4V(-15mV/ °C), max. Current: 45A		6.8-6.9(-10mV/ °C)	

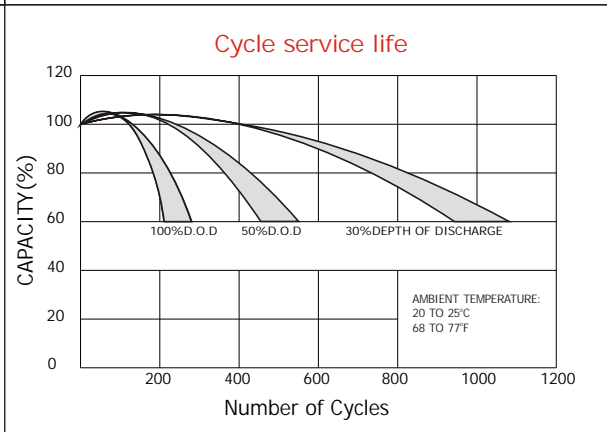
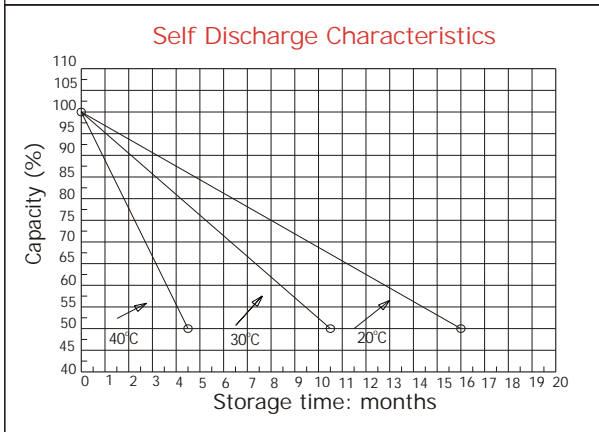
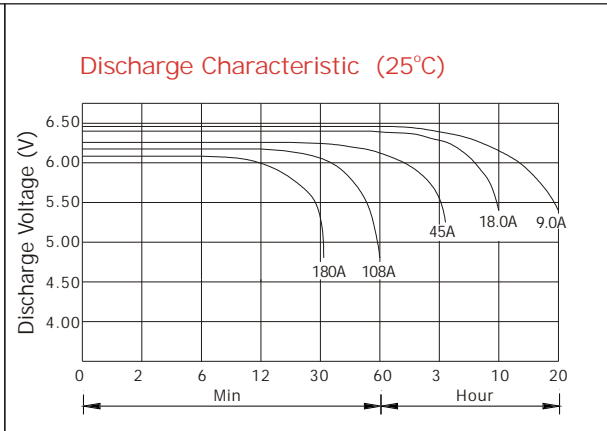
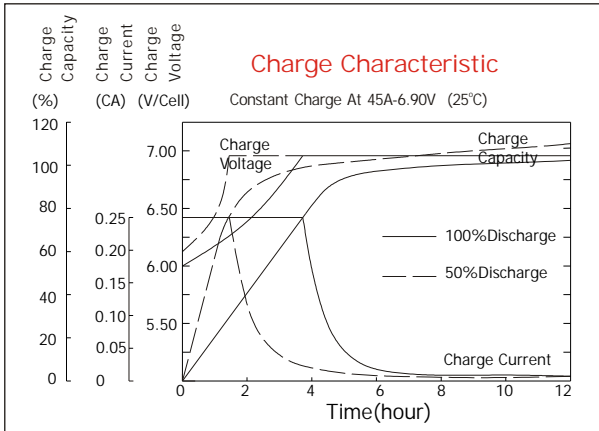

Constant current discharge ratings-amperes at 25°C

F. V/Time	5MIN	10MIN	15MIN	30MIN	1HR	3HR	5HR	10HR	20HR
1.60V	688	428	323	197	129	56.8	34.7	18.9	10.2
1.67V	646	406	311	188	128	54.6	34.0	18.7	9.85
1.70V	592	391	303	171	124	51.0	33.2	18.6	9.70
1.75V	580	379	293	163	118	49.3	32.5	18.6	9.45
1.80V	519	362	267	151	110	47.3	30.6	18.2	9.19
1.85V	458	345	240	139	103	45.6	28.6	18.0	8.94

Constant power discharge ratings-watts at 25°C

F. V/Time	5MIN	10MIN	15MIN	30MIN	1HR	3HR	5HR	10HR	20HR
1.60V	1207	773	589	355	233	101	58.6	38.8	20.4
1.67V	1164	753	582	347	232	97.6	58.4	38.6	19.7
1.70V	1096	746	577	325	228	93.2	57.6	38.3	19.4
1.75V	1103	743	572	315	224	91.0	57.1	37.9	18.9
1.80V	1009	732	531	301	211	88.3	55.4	37.4	18.4
1.85V	916	695	481	282	198	85.7	53.6	36.9	17.7

