



### GT-F Range

(Front Terminal) is recognised worldwide as the premium battery for telecommunications/IT applications. GT-F range reputation for long service life, combined with excellent high rate performance, also it the number one choice for high integrity, high specification UPS systems. GT-F front terminal monoblock's compact design and standard footprint, suitable for 19", 21" 23" ans ETSI racking, give users the benefit of increased energy density, with all electrical connector at the front, installation and inspection are simpler and quicker

### Application

- |                   |                         |
|-------------------|-------------------------|
| Telecom           | Communication Equipment |
| Control Equipment | Medical Equipment       |
| UPS               | Emergency Power System  |

### General Features

- Easy maintenance and installation
- No need for extra (wrench space) above battery
- Sealed and maintenance free operation
- Non-Spillable construction design
- ABS containers and covers (UL94HB, UL94V-0) optional
- Safety valve installation for explosion proof
- Maximized energy density for installation in relay rack trays
- High quality and high reliability
- Exceptional deep discharge recovery performance
- Flexibility design for multiple install positions

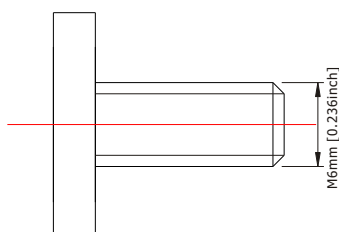

**Terminal Dimensions**

### Construction

- |           |                   |              |                    |
|-----------|-------------------|--------------|--------------------|
| Component | .....Raw material | Sealant      | .....Epoxy Resin   |
| Positive  | .....Lead dioxide | Safety valve | .....EPDR          |
| Negative  | .....Lead         | Terminal     | .....Copper        |
| Container | .....ABS          | Separator    | .....Fiber glass   |
| Cover     | .....ABS          | Electrolyte  | .....Sulfuric acid |

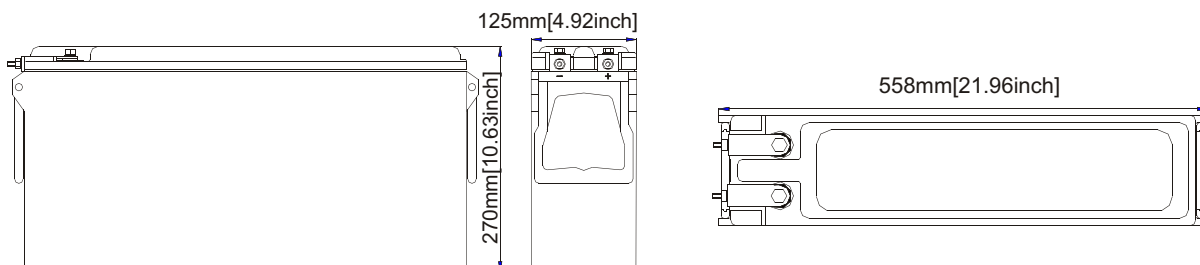

Battery Model	GT12-125F			
Designed Floating Life	12 Years			
Capacity(25°C)	20HR(6.50A,1.75V)	10HR(12.6A,1.75V)	5HR(21.5A,1.75V)	1HR(83A,1.75V)
	130AH	126AH	107.5AH	83AH
Dimensions	Length	Width	Height	Total Height
	558mm(21.96inch)	125mm(4.92inch)	270mm(10.63inch)	270mm(10.63inch)
Approx. Weight	49.0Kg (107.8 lbs)			
Internal Resistance	Full charged at 25°C :0.00388 Ohm			
Self Discharge	3% of capacity declined per month at (25°C)			
Capacity Affected by Temp.(20HR)	40°C	25°C	0°C	-15°C
	102%	100%	85%	65%
Charge Voltage(25°C)	Cycle use		Float use	
	14.4-14.8V(-30mV/ °C), max. Current: 31.25A		13.6-13.8(-20mV/ °C)	

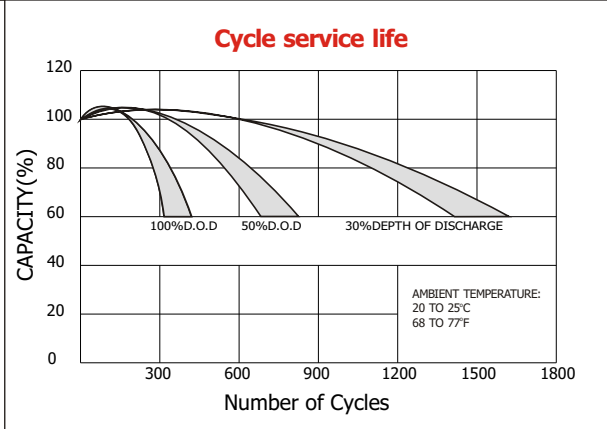
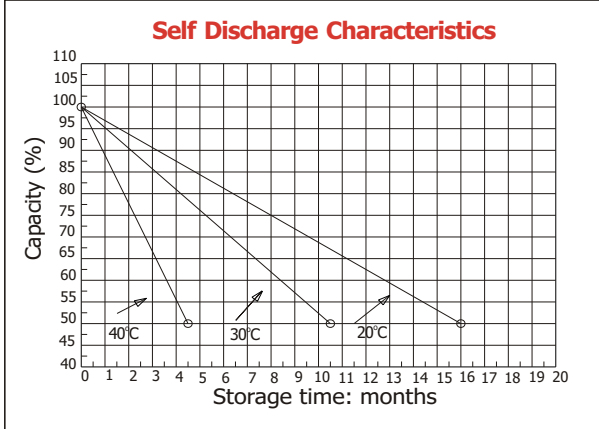
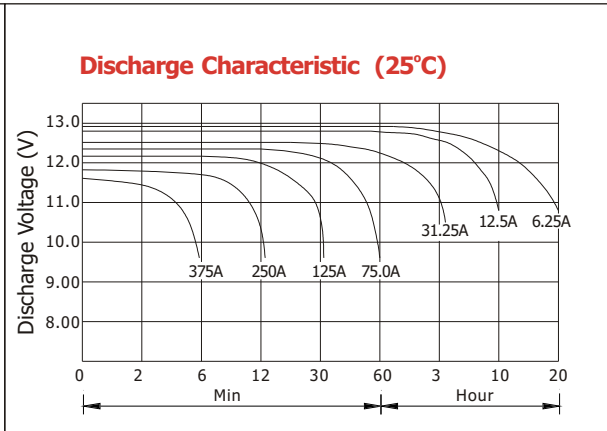
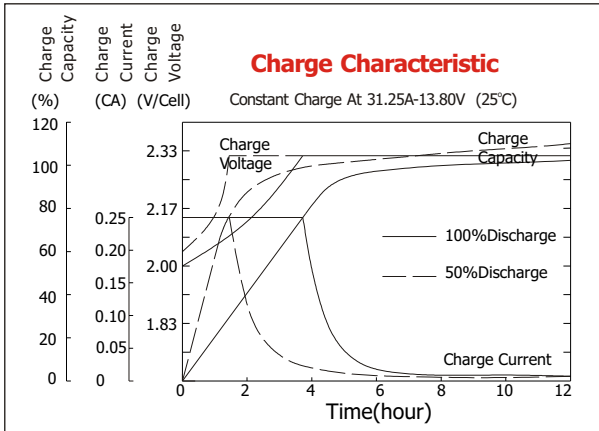

### Constant current discharge ratings-amperes at 25°C

F. V/Time	5MIN	15MIN	30MIN	1HR	3HR	5HR	8HR	10HR	20HR
1.60V	437	251	147	84	36.3	23.0	15.1	13.2	7.40
1.67V	388	241	143	83	35.8	22.3	14.8	12.8	6.85
1.70V	373	236	143	83	35.5	22.0	14.5	12.7	6.60
1.75V	332	225	138	83	35.3	21.5	14.0	12.6	6.50
1.80V	280	204	127	80	34.6	21.0	13.7	12.5	6.40
1.85V	271	174	114	76	33.6	20.5	13.2	12.4	6.30

### Constant power discharge ratings-watts at 25°C

F. V/Time	5MIN	15MIN	30MIN	1HR	3HR	5HR	8HR	10HR	20HR
1.60V	670	350	220	138	57.7	42.7	29.6	24.8	12.8
1.67V	650	345	216	135	56.4	41.9	28.5	23.9	12.2
1.70V	635	344	215	134	56.0	41.7	28.1	23.8	12.1
1.75V	592	334	214	133	55.6	41.0	27.7	23.3	11.7
1.80V	540	319	214	124	54.0	40.6	27.1	22.5	11.3
1.85V	490	308	208	116	53.1	40.2	26.5	22.1	10.8

