



### GT-F Range

(Front Terminal) is recognised worldwide as the premium battery for telecommunications/IT applications. GT-F range reputation for long service life, combined with excellent high rate performance, also it the number one choice for high integrity, high specification UPS systems. GT-F front terminal monoblock's compact design and standard footprint, suitable for 19", 21" 23" and ETSI racking, give users the benefit of increased energy density, with all electrical connector at the front, installation and inspection are simpler and quicker

### Application

- |                   |                         |
|-------------------|-------------------------|
| Telecom           | Communication Equipment |
| Control Equipment | Medical Equipment       |
| UPS               | Emergency Power System  |

### General Features

- Easy maintenance and installation
- No need for extra (wrench space) above battery
- Sealed and maintenance free operation
- Non-Spillable construction design
- ABS containers and covers (UL94HB, UL94V-0) optional
- Safety valve installation for explosion proof
- Maximized energy density for installation in relay rack trays
- High quality and high reliability
- Exceptional deep discharge recovery performance
- Flexibility design for multiple install positions

### Construction

- |           |                   |              |                    |
|-----------|-------------------|--------------|--------------------|
| Component | .....Raw material | Sealant      | .....Epoxy Resin   |
| Positive  | .....Lead dioxide | Safety valve | .....EPDR          |
| Negative  | .....Lead         | Terminal     | .....Copper        |
| Container | .....ABS          | Separator    | .....Fiber glass   |
| Cover     | .....ABS          | Electrolyte  | .....Sulfuric acid |

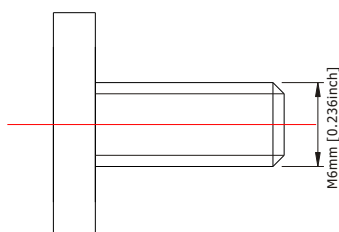

**Terminal Dimensions**

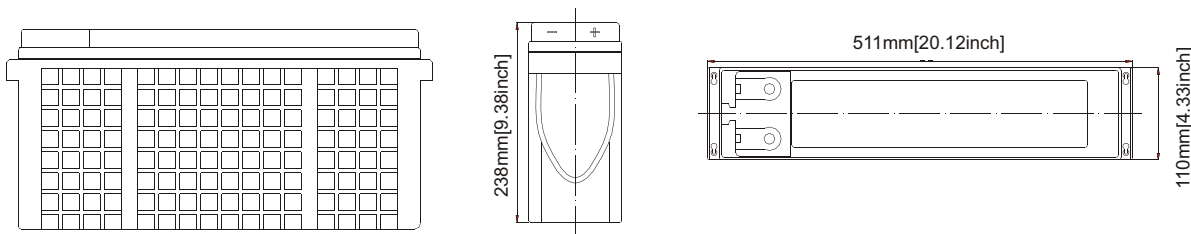

Battery Model	GT12-100F			
Designed Floating Life	12 Years			
Capacity(25°C)	20HR(5.20A,1.75V)	10HR(10.3A,1.75V)	5HR(18.7A,1.75V)	1HR(59A,1.75V)
	104AH	104AH	93.5AH	59AH
Dimensions	Length	Width	Height	Total Height
	511mm(20.12inch)	110mm(4.33inch)	238mm(9.37inch)	238mm(9.37inch)
Approx. Weight	34.0Kg (74.8 lbs)			
Internal Resistance	Full charged at 25°C :0.0054 Ohm			
Self Discharge	3% of capacity declined per month at (25°C)			
Capacity Affected by Temp.(20HR)	40°C	25°C	0°C	-15°C
	102%	100%	85%	65%
Charge Voltage(25°C)	Cycle use		Float use	
	14.4-14.8V(-30mV/ °C), max. Current: 25A		13.6-13.8(-20mV/ °C)	

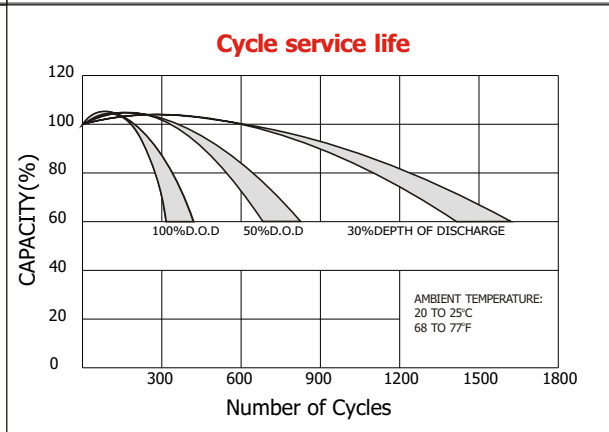
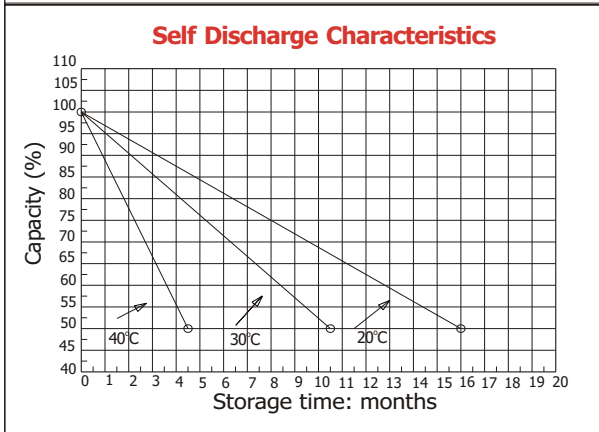
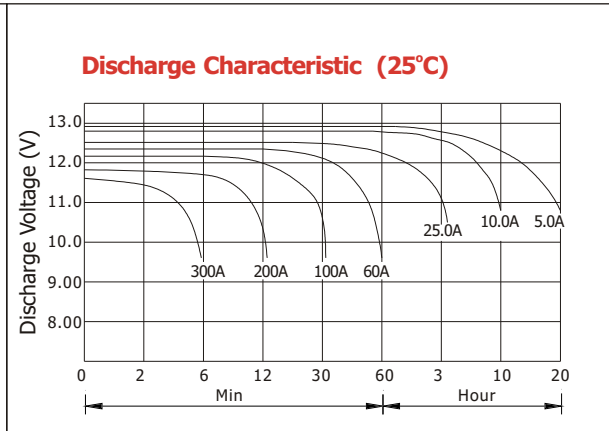
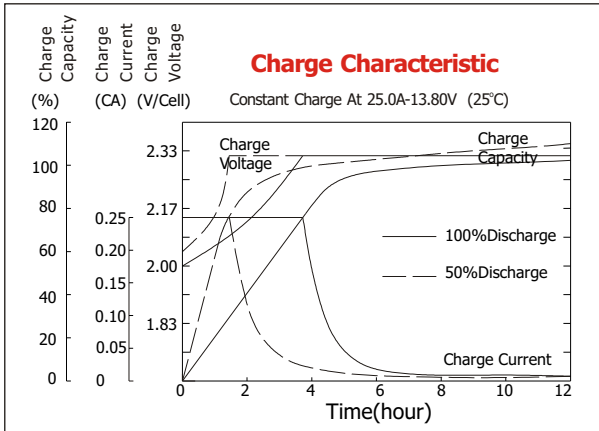

**Constant current discharge ratings-amperes at 25°C**

F. V/Time	5MIN	15MIN	30MIN	1HR	3HR	5HR	8HR	10HR	20HR
1.60V	345	177	106	63	28.7	18.9	13.1	10.6	5.40
1.67V	314	167	104	62	28.4	18.8	13.0	10.5	5.33
1.70V	304	163	103	62	28.3	18.7	12.9	10.4	5.30
1.75V	274	154	100	59	28.0	18.7	12.8	10.3	5.20
1.80V	247	146	98	57	27.8	18.5	12.6	10.0	5.15
1.85V	218	136	93	52	24.7	17.5	12.0	9.8	5.00

**Constant power discharge ratings-watts at 25°C**

F. V/Time	5MIN	15MIN	30MIN	1HR	3HR	5HR	8HR	10HR	20HR
1.60V	466	273	178	103	48.8	33.8	23.7	19.8	11.10
1.67V	462	271	177	100	48.8	33.8	23.7	19.8	11.10
1.70V	460	270	177	102	48.7	33.8	23.7	19.8	11.10
1.75V	455	268	176	102	48.3	33.7	23.5	19.7	11.10
1.80V	445	263	175	101	48.0	33.5	23.3	19.5	11.00
1.85V	404	253	169	95	46.2	32.7	22.7	19.2	10.70

